

- NOTES:**  
 1. ALL PART TO BE BULK PACKED  
 2. CONTACTS SUPPLIED UNASSEMBLED  
 3. ALL DIMENSION ARE REFERENCE ONLY

ASS'Y P/N	COUPLING RING COLOR
3280-XSG-5XXWCC1	WHITE
3280-XSG-5XXWCC2	RED
3280-XSG-5XXWCC3	BLUE
3280-XSG-5XXWCC4	LIGHT GREY
3280-XSG-5XXWCC5	YELLOW
3280-XSG-5XXWCC6	MAROON
3280-XSG-5XXWCC7	GREEN

CONN. KIT P/N	NO. OF CONTACTS
3280-4SG-5XXW	4-#20
3280-5SG-5XXW	5-#20
3280-6SG-5XXW	6-#20
3280-7SG-5XXW	7-#20
3280-8SG-5XXW	8-#20
3280-9SG-5XXW	9-#20

CONN. KIT P/N	GROMMET FOR CABLE	"X" DIM.
3280-XSG-515W	.156 I.D. FOR CABLE .15-.17 O.D. [3.8-4.3mm]	Ø0.77 [19.6mm]
3280-XSG-518W	.187 I.D. FOR CABLE .18-.20 O.D. [4.6-5.1mm]	Ø0.77 [19.6mm]
3280-XSG-521W	.225 I.D. FOR CABLE .21-.23 O.D. [5.3-5.8mm]	Ø0.77 [19.6mm]
3280-XSG-524W	.250 I.D. FOR CABLE .24-.27 O.D. [6.1-6.8mm]	Ø0.77 [19.6mm]
3280-XSG-528W	.285 I.D. FOR CABLE .28-.29 O.D. [7.1-7.4mm]	Ø0.77 [19.6mm]
3280-XSG-530W	.312 I.D. FOR CABLE .30-.32 O.D. [7.6-8.1mm]	Ø0.77 [19.6mm]
3280-XSG-535W	.375 I.D. FOR CABLE .35-.40 O.D. [8.9-10.2mm]	Ø0.83 [21.1mm]

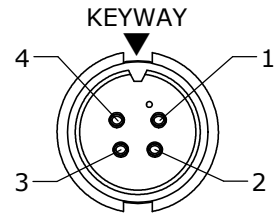

**FACE VIEW**  
P/N: 3280-4SG-5XXW

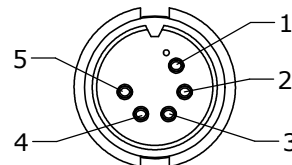

**FACE VIEW**  
P/N: 3280-5SG-5XXW

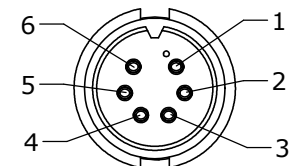

**FACE VIEW**  
P/N: 3280-6SG-5XXW

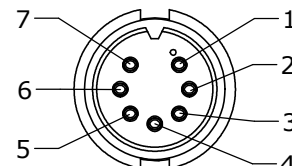

**FACE VIEW**  
P/N: 3280-7SG-5XXW

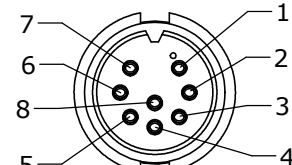

**FACE VIEW**  
P/N: 3280-8SG-5XXW

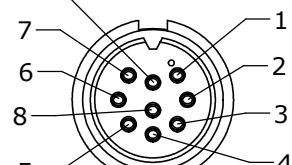

**FACE VIEW**  
P/N: 3280-9SG-5XXW

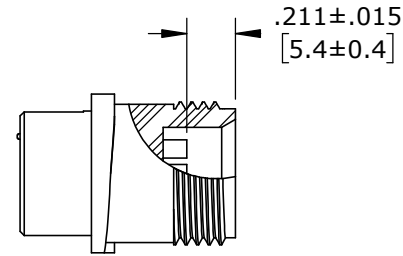

**CONTACT HEIGHTS**  
FOR CUSTOMER REFERENCE

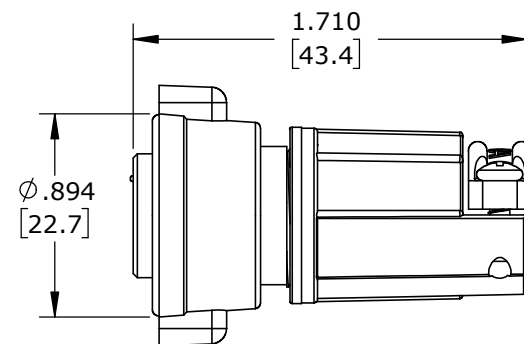
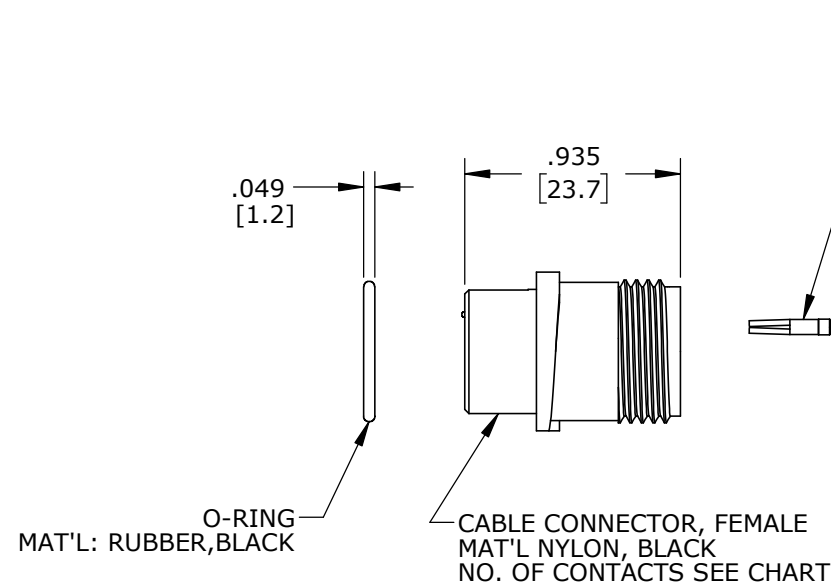

**ASSEMBLED VIEW**  
FOR CUSTOMER REFERENCE

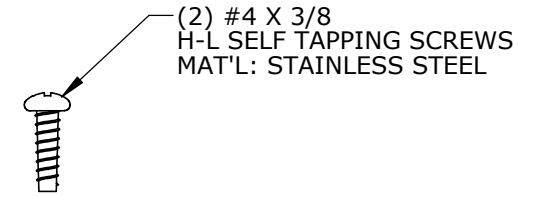
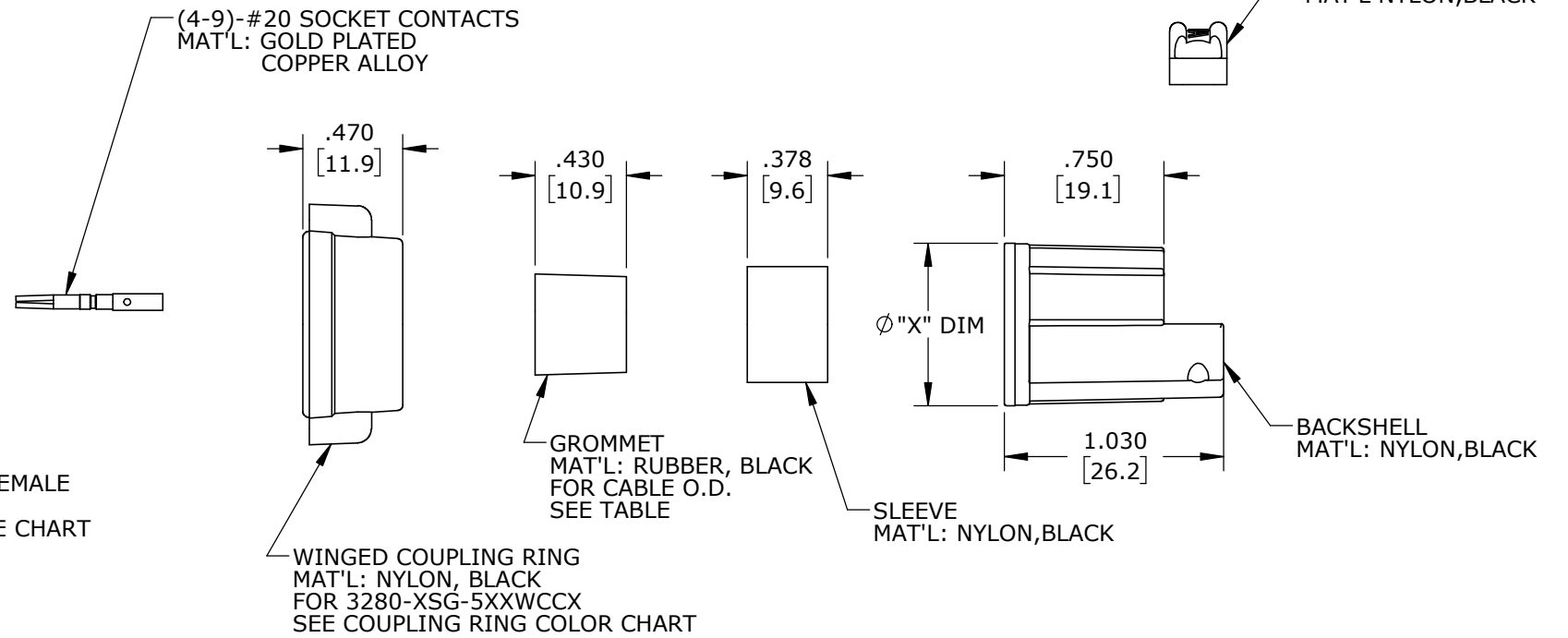

GROMMET SIZE  
SEE LIST

NO OF CONTACTS

**CUSTOMER APPROVAL**  
 THIS DOCUMENT CONTAINS CONFIDENTIAL INFORMATION PROPRIETARY TO CONXALL CORPORATION. ANY REPRODUCTION, DISCLOSURE, OR USE OF THIS DOCUMENT /INFORMATION IS EXPRESSLY PROHIBITED UNLESS AUTHORIZED IN WRITING BY CONXALL CORPORATION.  
 APPROVED BY: \_\_\_\_\_  
 DATE: \_\_\_\_\_

A	AN	04-09-21	DRAWING CREATED DOR 15-E253SL #39
REV.	INIT.	DATE	DESCRIPTION
	AN	02-22-21	ORIG. DRAWN BY: AN DATE: 02-22-21
ALL INFORMATION ILLUSTRATED IS THE PROPERTY OF "CONXALL CORPORATION". UNAUTHORIZED DUPLICATION OR DISTRIBUTION OF THIS DOCUMENT IS PROHIBITED.			 601 E. WILDWOOD VILLA PARK, IL 60181
ALL UNITS ARE IN FEET, INCHES, FRACTION OF INCHES AND DECIMALS.			
APPROVED BY:		TITLE: CONNECTOR ASS'Y KIT (4-9) #20 SOCKET CONTACTS (CRIMP) MULTI-CON-X, W/WINGED COUPLING NUT	
SCALE	SIZE	SHEET	CUSTOMER: STANDARD PRODUCT
NTS	B	1 OF 1	
FILE:	DIRECTORY:	PART NUMBER:	REV
3280-XSG-5XXW(CCX)	SLW	3280-XSG-5XXW(CCX)	A

DIMENSIONS IN BRACKETS [ ] ARE METRIC

**RoHS COMPLIANT**

CUSTOMER PRINT

PART NUMBER: 3280-XSG-5XXW(CCX)